

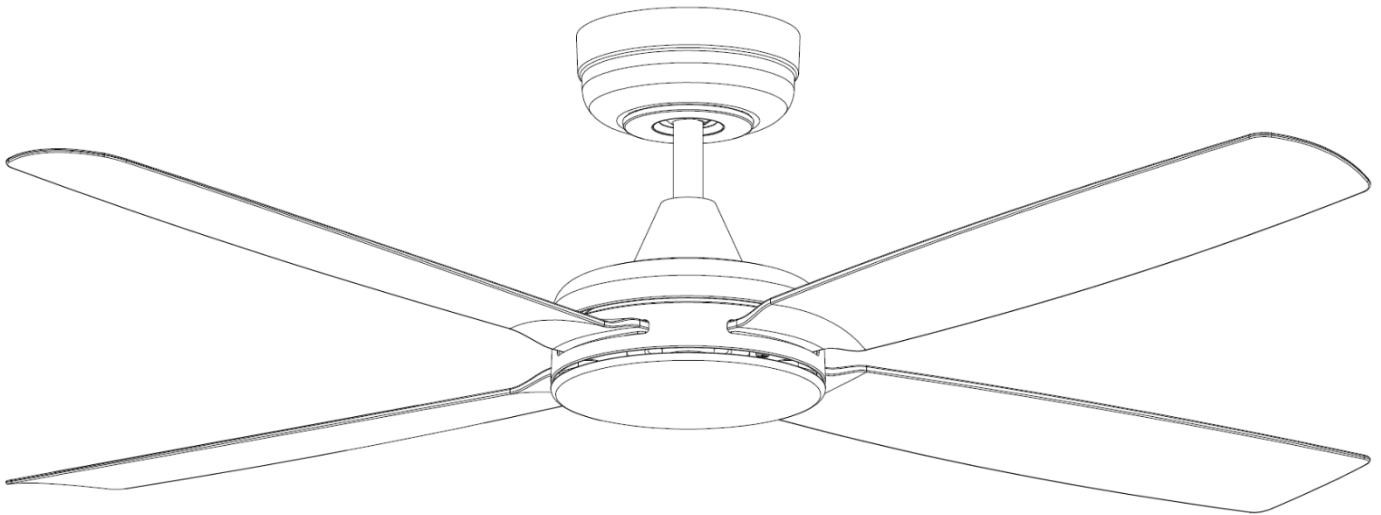

THE QUALITY BRAND IN FANS



## CAUTION

**DO NOT THROW AWAY THIS BOOK! READ ALL INSTRUCTIONS  
CAREFULLY BEFORE INSTALLATION AND FAN OPERATION.**

Minor design changes or otherwise may result in slight variations between the product illustrated and that which is contained within this package

---

**INSTALLATION AND OPERATION INSTRUCTION BOOK, MRIN008493**

**Colombo SERIES**

**Models: FC1180134WH**

**DC CEILING FAN**

---

# TABLE OF CONTENTS

---

INTRODUCTION & SPECIFICATIONS..... 1

SAFETY PRECAUTIONS.....3

UNPACKING YOUR CEILING FAN .....6

FAN INSTALLATION INSTRUCTIONS.....7

REMOTE CONTROLLER PAIRING INSTRUCTIONS ..... 10

WIRING DIAGRAM ..... 13

WALL CONTROLLER INSTRUCTIONS ..... 14

REMOTE CONTROLLER INSTRUCTIONS ..... 15

INFORMATION FOR LICENSED ELECTRICIAN AND FAN OWNERS..... 17

IMPORTANT FACTS..... 18

# INTRODUCTION & SPECIFICATIONS

## CONGRATULATIONS ON YOUR CHOICE

Thank you and we are delighted you have chosen a MERCATOR ceiling fan for your home. Please read all instructions carefully before assembly and use.

### SAFETY NOTICES

#### WARNING / CAUTION

A WARNING / CAUTION notice denotes a hazard. It calls attention to an installation procedure, operating procedure, maintenance procedure, or the like, that if not correctly performed or adhered to, could result in damage to this appliance, personal injury or death. Do not proceed beyond a WARNING / CAUTION notice until the indicated conditions are fully understood and met.

### SAFETY SYMBOLS

	Alternating current
	Protective earth
	Warning/Caution

### TECHNICAL SPECIFICATIONS

MODEL	COLOUR	RATED VOLTAGE (V)	MOTOR POWER (W)	SIZE (mm)	WEIGHT (kg)	AIRFLOW*
FC1180134WH	WHITE	220-240V~	DC 30W	1320	4.5	Max. 10000 m <sup>3</sup> /hr

\* Based on accredited testing to U.S. D.O.E. airflow standards.

# INTRODUCTION & SPECIFICATIONS

## SPARE PARTS LIST

MODEL	BLADES	REMOTE TRANSMITTER	WALL CONTROLLER	RECEIVER AND REMOTE KIT	SCREWS PACK	HANGER BRACKET
FC1180134WH	FL1180134WH	FRM124	FRMDC118	FRMW1180134	FR1180134	FHB2110093

## OPTIONAL ACCESSORIES (SOLD SEPARATELY)

MODEL	600mm EXTENSION ROD (FD...) + WIRING LOOMS (XFC...)	900mm EXTENSION ROD (FD...) + WIRING LOOMS (XFC...)
FC1180134WH	FD360600WH + XFC8283	FD360900WH + XFC8284

# SAFETY PRECAUTIONS

Please observe the following general safety precautions carefully before and during all phases of handling, installation, removal, operation and maintenance of this product. Failure to comply with these precautions violates safety standards of design, manufacture and intended use of the product. Mercator assumes no liability for customer's failure to comply with these requirements.



## SAFETY WARNINGS

1. Read all instructions and safety information. Review assembly diagrams provided before installing your new ceiling fan.
2. **This fan must be installed by a licensed and qualified electrician according to Australian Wiring Rules and local authority regulations.**
3. This appliance is not intended for use by persons (including children) with reduced physical, sensory or mental capabilities, or lack of experience and knowledge, unless they have been given supervision or instruction concerning use of the appliance by a person responsible for their safety.
4. Children should be supervised to ensure that they do not play with the appliance.
5. **All electrical works must only be undertaken after disconnection of the power by removing fuses or turning off the circuit breaker, to ensure all pole isolation of the electrical supply.**
6. This fan may be operated only with a 2-pole switch with a 3mm contact opening each.
7. Do not use outdoors where it could be exposed to water or moisture.
8. **WARNING:** If unusual oscillating movement is observed, immediately stop using the ceiling fan and contact the manufacturer, its service agent or suitably qualified person.
9. The replacement of parts of the safety suspension system device shall be performed by the manufacturer, its service agent or suitably qualified person.
10. The fixing means for attachment to the ceiling such as hooks or other devices shall be fixed with a sufficient strength to withstand 4 times the weight of the ceiling fan.
11. The mounting of the suspension system shall be performed by the manufacturer, its service agent or suitably qualified person.
12. This manual is not intended to instruct or assist untrained or unqualified persons to install this ceiling fan.
13. **It is the responsibility of qualified, licensed installer and user to apply common sense and care at all times during installation and operation.**
14. If a remote control is used for controlling ceiling fan, isolation wall switch to remote control receiver must be installed.
15. Always turn off the fan and ensure the blades have completely stopped rotating when servicing, working near the fan or otherwise in the vicinity of the fan.
16. Do not insert anything into the fan blades while the fan is operating.
17. Inspect the fan regularly to ensure that there is no damage or fault and the fan is in safe operating condition. If, at any time, the fan is not in safe operating condition, have the fan serviced or repaired before any further use. Only use identical parts manufactured and guaranteed by the manufacturer to service or repair the fan. The fan must only be serviced or repaired by a licensed and qualified electrician according to Australian Wiring Rules and local authority regulations.
18. **Do not overtighten the blade retaining screws. Overtightening could result in a failure of the blade and property damage or personal injury.**

# SAFETY PRECAUTIONS

## HOW TO CHOOSE A PROPER LOCATION FOR CEILING FAN

1. According to regulations and to provide a safe clearance from the floor, the lowest point on the fan blade must be at least 2.1 metres (7 feet) from the floor.
2. For fan installed enclosed outdoors, the fan must be installed at least 1.5m from the perimeter of roof/eaves of the enclosure to protect the product from direct or indirect rainwater or sunlight.
3. The chosen location for the fan must not allow the rotating blades to come into contact with any object or any person.
4. Please check carefully and make sure that ceiling joists are strong enough and of adequate size to support the weight of about 35 kg.
5. To reduce the risk of fire, electrical shock or personal injury, please make sure that the fan mounting bracket is directly supported from the building structure. Do not mount to an outlet box.
6. The mounting bracket must be firmly screwed to a load bearing building structure e.g. a concrete ceiling, steel structure, or a timber frame. If additional timber frames are to be added, those must be securely nailed or screwed between the beams.
7. Attach fan blades after the fan motor housing is installed and properly secured. Keep the fan motor and blades in the original package until it is ready to be installed.
8. Check and confirm, after the fan is completely installed, that all connections are proper and secure to prevent the fan from falling or causing property damages or personal injury.
9. Take care not to bend or damage the motor Drive Shaft or Fan Blades when handling or installing them. If such defect is noticed, do not remove the fan from the ceiling and contact the Customer Service before installation of the ceiling fan.
10. Both the fan with light kit and the hanging bracket must be earthed.
11. Do not remove the fan from ceiling after installation.
12. Make sure electricity is turned off at the main power box before commencing work. Turn off the power by removing fuse or turning off circuit breaker before installing the fan.
13. Use only the included remote controller, using other remote controller will void the warranty and may cause the fan's functions to fail. Do not use solid state dimmer controllers.

## ELECTRICIANS AND INSTALLERS NOTICES

1. The **AUSTRALIAN CONSUMER LAW ACT 2010** mandates consumer protection against defects or poor workmanship in provision of services (such as installing a ceiling fan). To protect yourself and the consumer, these instructions must be followed. Failure to do so may result in the consumer making claim against you for consequential loss or damage.
2. If there are any problems with the products at the time of installation, the installer must contact the MERCATOR Customer Care Hotline (located on the Warranty Card) **BEFORE** leaving the job site.
3. Do not remove the fan from the ceiling once installed, unless instructed to do so.

# SAFETY PRECAUTIONS

## CLEARANCES AND ANGLED CEILING

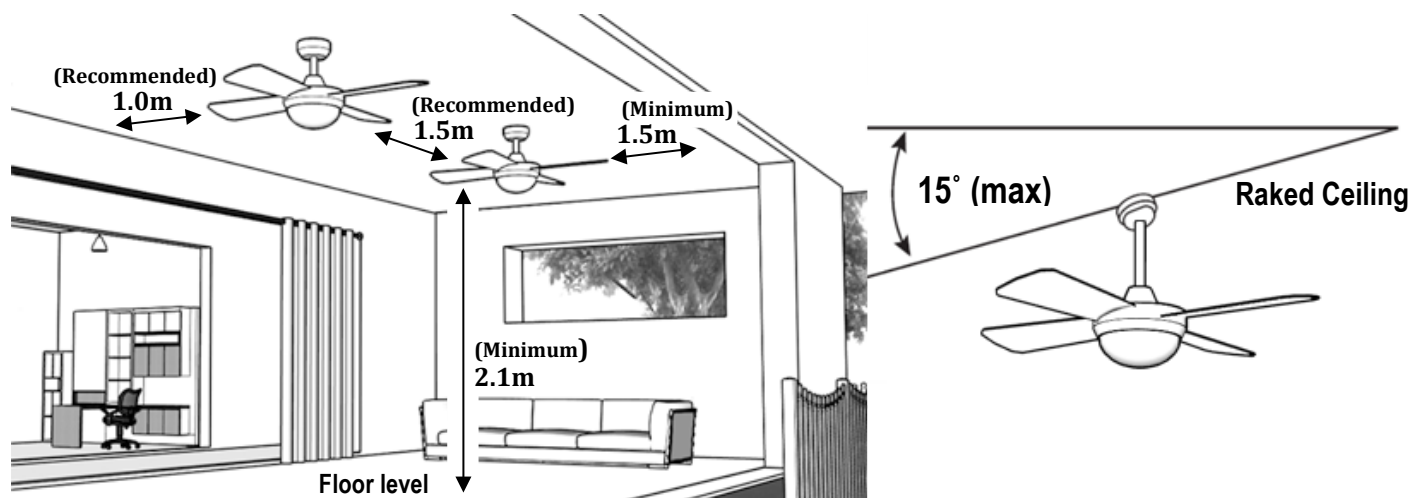

*\*Fan shown are for illustration purposes only. Actual product may vary.*

# UNPACKING YOUR CEILING FAN

## INCLUDED WITH YOUR FAN

Open the original carton and verify the following items are available for the standard purchase of this product. If there are any missing or mechanically damaged items, contact the Mercator Customer Care. Do not throw away the carton or other packaging material as it may be needed if warranty replacement or repair is ever necessary.

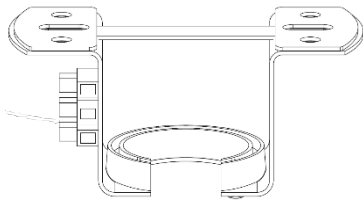

1 x Mounting Bracket

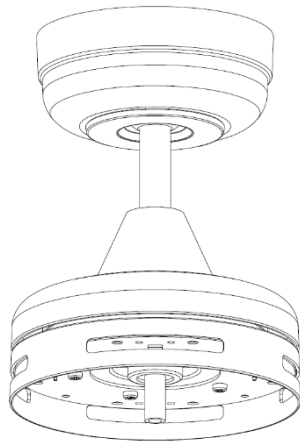

1 x Motor Assembly



4 x Blades

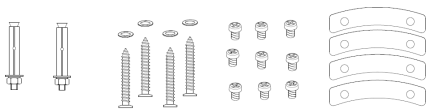

Screws Package

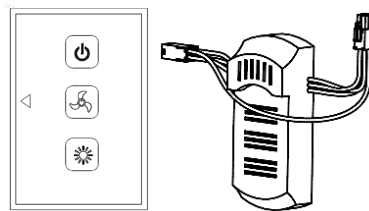

1 x Remote Controller Set

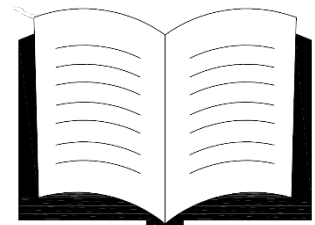

1 x Instruction Manual & Warranty Card



1 x Cover



- *Use of an unapproved remote controller will void the warranty. Do not control the operation of this fan from any remote controller that is not approved by Mercator for use with this fan.*
- *Do not use solid state controllers.*



# FAN INSTALLATION INSTRUCTIONS



- Make sure electricity is turned off at the main power box before commencing work. Turn off the power by removing fuse or turning off circuit breaker before installing the fan and replacing the lamp.
- The lowest point on the fan blade must be at least 2.1 metres (7 feet) from the floor.
- Make sure that ceiling joists are strong enough and of adequate size to support the weight of the fan of about 35 kg.

	<p>1. Align blades with the pillars on motor. Screw in the provided blade installation screws with fan blade bracket for each blade.</p> <p><b>Note: hand tighten only! Do not use power tools to prevent over-tightening.</b></p>
	<p>2. Align and twist the plastic cover in place.</p>
	<p>3. Fan and mounting bracket must be earthed during installation. Secure the mounting bracket to the ceiling joist or suitable piece of timber inserted between the ceiling joists.</p> <p>The bracket should be attached with four timber screws and washers supplied.</p>

# FAN INSTALLATION INSTRUCTIONS

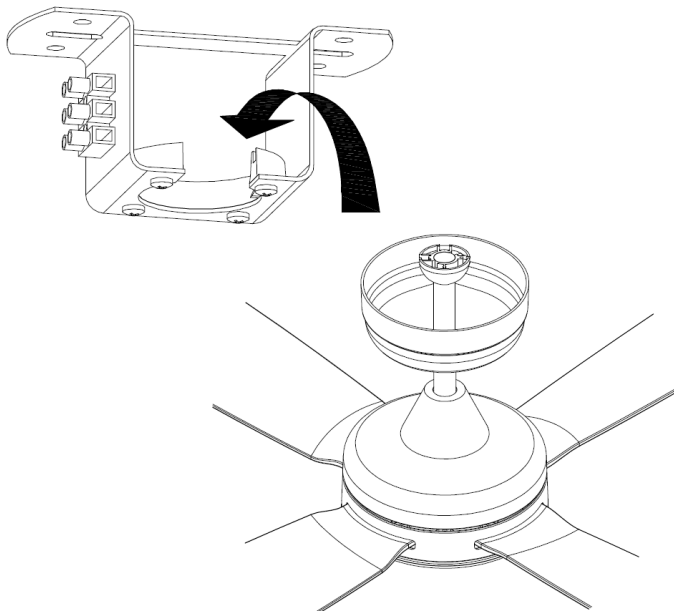

4. Carefully lift motor assembly onto mounting bracket. Install the ball joint onto the mounting bracket opening.

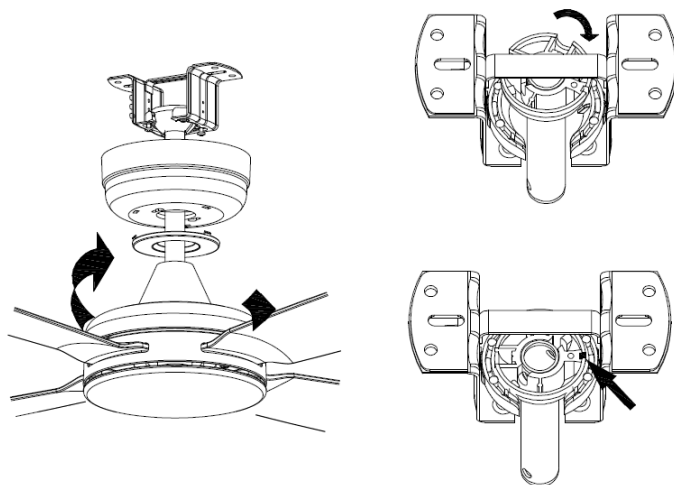

5. Rotate fan until notch on down rod ball engages the ridge on the mounting bracket. This will allow hands free wiring.

## FAN INSTALLATION INSTRUCTIONS

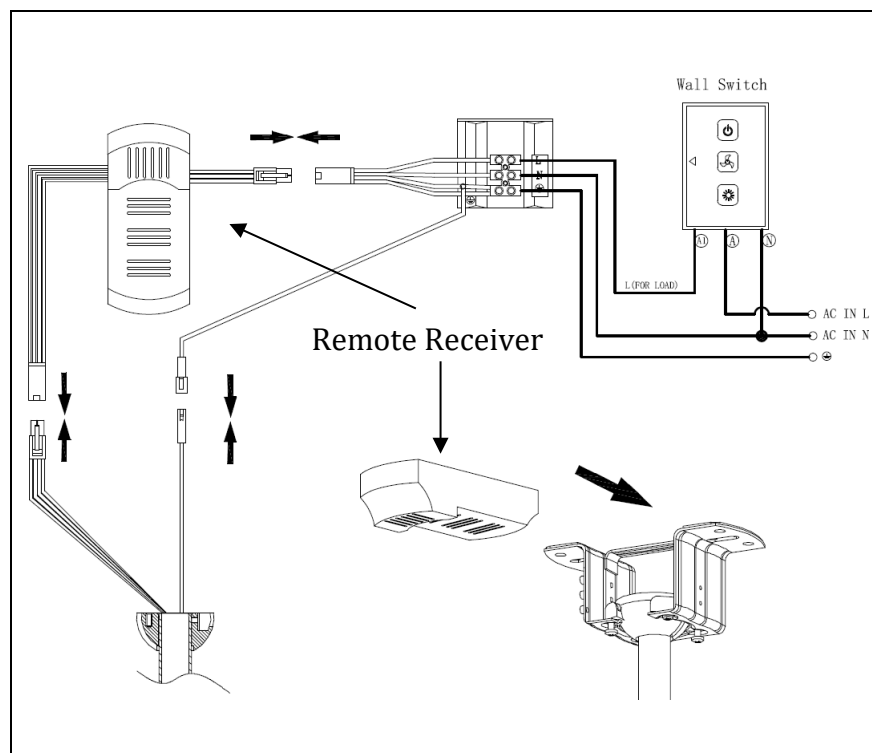

6. Connect the receiver as per the provided wiring diagram.

Insert the receiver into the mounting bracket with the flat side facing the ceiling as shown.

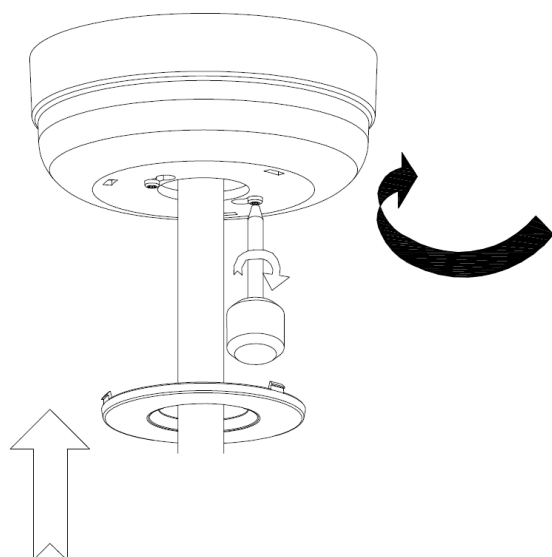

- Align Key holes on canopy with protruding screws heads from the mounting bracket.

Rotate canopy counterclockwise until screw heads engage the key slots fully. Tighten screws.

Lift bottom lid and lock to bottom of canopy.

Take care to not damage or cut wires and antenna.

# REMOTE CONTROLLER PAIRING INSTRUCTIONS

\*Optional handheld remote controller FRM124

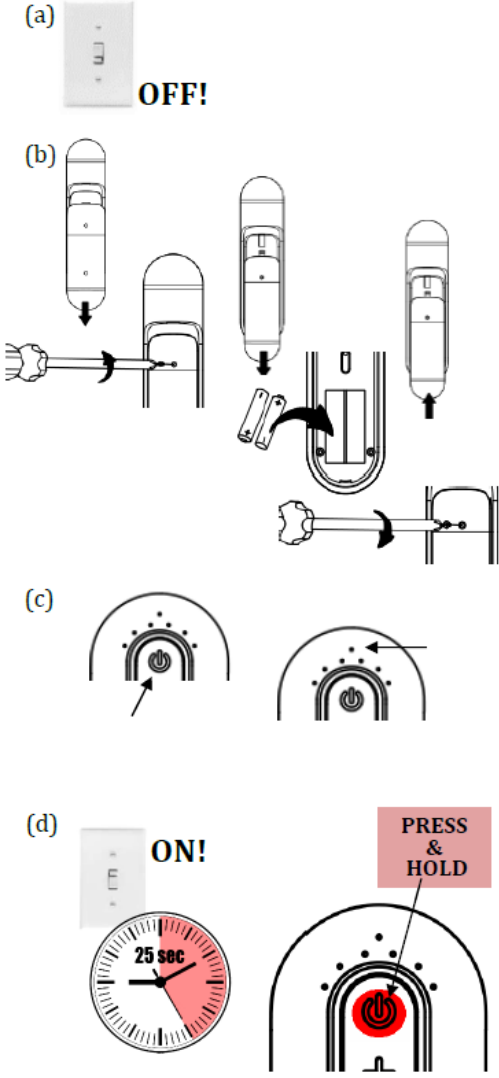
	<h2>Fan &amp; Remote Pairing</h2> <h3>Important Notes</h3> <ul style="list-style-type: none"><li>• Keep the fan and remote within 8.0 m of each other during pairing.</li><li>• The fan will ignore pairing requests if the handset is already paired.</li><li>• Each fan receiver can be paired with up to 4 remote handsets.</li><li>• When pairing multiple fans, only power ON one fan at a time to avoid interference.</li></ul> <p>(a) <b>Switch OFF</b> the wall switch for the fan to be paired. If more than one fan is installed, switch OFF power to ALL fans.</p> <p>(b) <b>Insert 2 x AAA</b> batteries into the remote.</p> <p>(c) <b>Press any button</b> to ensure the LED lights up, confirming batteries are good and the remote is operational.</p> <p>(d) Ensure power to the fan has been OFF for <b>more than 1 minute</b>.</p> <p>(e) Turn ON power only to the fan you wish to pair.</p> <h3>Pairing Procedure</h3> <p>➤ Within 25 seconds of powering ON the fan: → Press and hold the pairing button for 5 seconds.</p> <p><input checked="" type="checkbox"/> <b>Successful Pairing:</b></p> <p>➤ The fan will beep ONCE, confirming the pairing is SUCCESSFUL.</p> <h3>Additional Information</h3> <p>➤ If the handset is already paired with the fan, no beep will sound and the pairing will be ignored.</p> <p>➤ The receiver exits pairing mode after 25 seconds.</p> <p>➤ Test all buttons on the remote to ensure full functionality.</p>
--	---

## IMPORTANT

Fan installed without its own individual power switch disallowing intended pairing process is considered IMPROPER installation.

# REMOTE CONTROLLER PAIRING INSTRUCTIONS

## PAIRING REMOTE RECEIVER & TRANSMITTER FOR FAN OPERATION

Fan new receiver must undergo “pairing” process before it can communicate with remote transmitter.

**End user will be required to carry out “pairing” process:**

- Right after fan installation (new handset has yet to be paired with receiver \*)
- If remote does not work properly
- After replacing a receiver
- After replacing a remote handset
- If there is more than 1 ceiling fan of the same model and you wish to control all of them using a single remote handset (fans need to be less than 8.0m away from handset).

*(\* Pairing request is ignored if handset has already been paired with the receiver)*



**Electrician MUST install individual wall switch on fan fixed wirings so that power can be disconnected for carrying out pairing process.**

**Fan installed without its own individual power switch disallowing intended pairing process is considered IMPROPER installation. Rectification works related are not covered by warranty.**

### POSSIBLE CAUSE THAT MAY AFFECT EFFECTIVE RECEPTION OF REMOTE SIGNAL

- Remote controller battery level low (dim LED indicator light)
- Distance between fan and transmitter (keep distance less than 8 meters)
- Antenna wire is trapped by hanger bracket, receiver housing or other wires inside canopy.
- Presence of excessive electrical noise in power supply (e.g., by other power tools)
- Presence of strong radio frequency (RF) emitting devices between remote and fan.

# REMOTE CONTROLLER PAIRING INSTRUCTIONS

## MULTIPLE RECEIVER & TRANSMITTER PAIRING OPERATION

The remote receiver (motor controller) can store up to FOUR different remote controllers (remote handset). Pairing must be performed one fan (receiver) and one remote controller at a time.

### USING ONE REMOTE HANDSET TO CONTROL MULTIPLE FANS

*# Make sure remote handset is within 8 metres from ceiling fan in straight line distance.*

1. Use a same remote handset to pair with all target fans, one fan at a time.
2. Turn on the power / isolation switch to ALL fans.
3. Try different speed setting on remote handset to ensure all the fans is now fully functional. If not repeat the pairing process for the non-functional fan. (Fan should be <8m from remote)

### USING MULTIPLE REMOTE HANDSET TO CONTROL ONE FAN

*# Make sure remote handset is within 8 metres from ceiling fan in straight line distance.*

*# Fan can memorize up to 4 different remotes. Pairing with the 5th remotes will erase the earliest paired remote in memory in first in first out fashion.*

1. Pair a different remote handset with the same target fans, one remote handset at a time.
2. Keep the power / isolation switch ON to the fan once pairing is completed.
3. Try different speed setting on each remote handset to ensure fan respond to all remotes. If not repeat pairing process for the non-functional remote.

### ERASING REMOTE(S) OFF FAN MEMORY

*# Make sure remote handset is within 8 metres from ceiling fan in straight line distance.*

*# After the process, the handset used to initiate a memory clean **will remain in pairing and operational.***

*# Please ensure that fan and light (if applicable) are turned off prior to initiating this process.*

1. Turn **OFF** the power/isolation switch for the fan for at least 1 minute. (Electrician must install all poles disconnection / isolation switch in the fixed wirings for the fan)
2. Turn **ON** the fan power / isolation switch and within 25 seconds ...

Press & hold down the  (downlight ON/OFF) button for 5 seconds.

Once you hear a beep, unpairing process is completed.

3. All remote handsets other than the one used to initiate a memory erase will be cleaned out fan memory and no longer controls the fan.

# WIRING DIAGRAM

## WIRING DIAGRAM FOR FAN CONTROLLED WITH REMOTE CONTROLLER

### NOTE:

1. Isolation wall switch must be installed.
2. Must use the wall switch provided with this product.

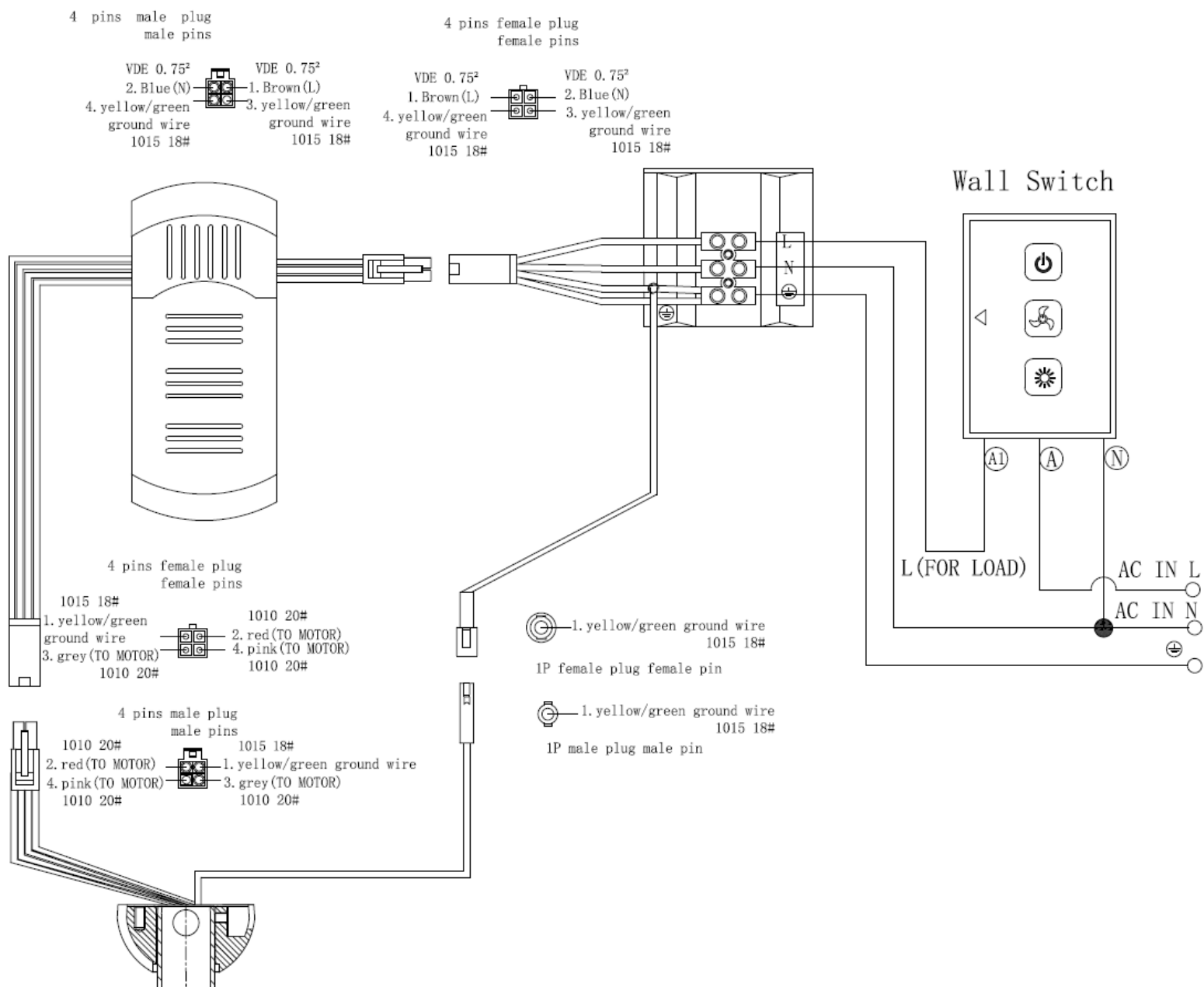

# WALL CONTROLLER INSTRUCTIONS

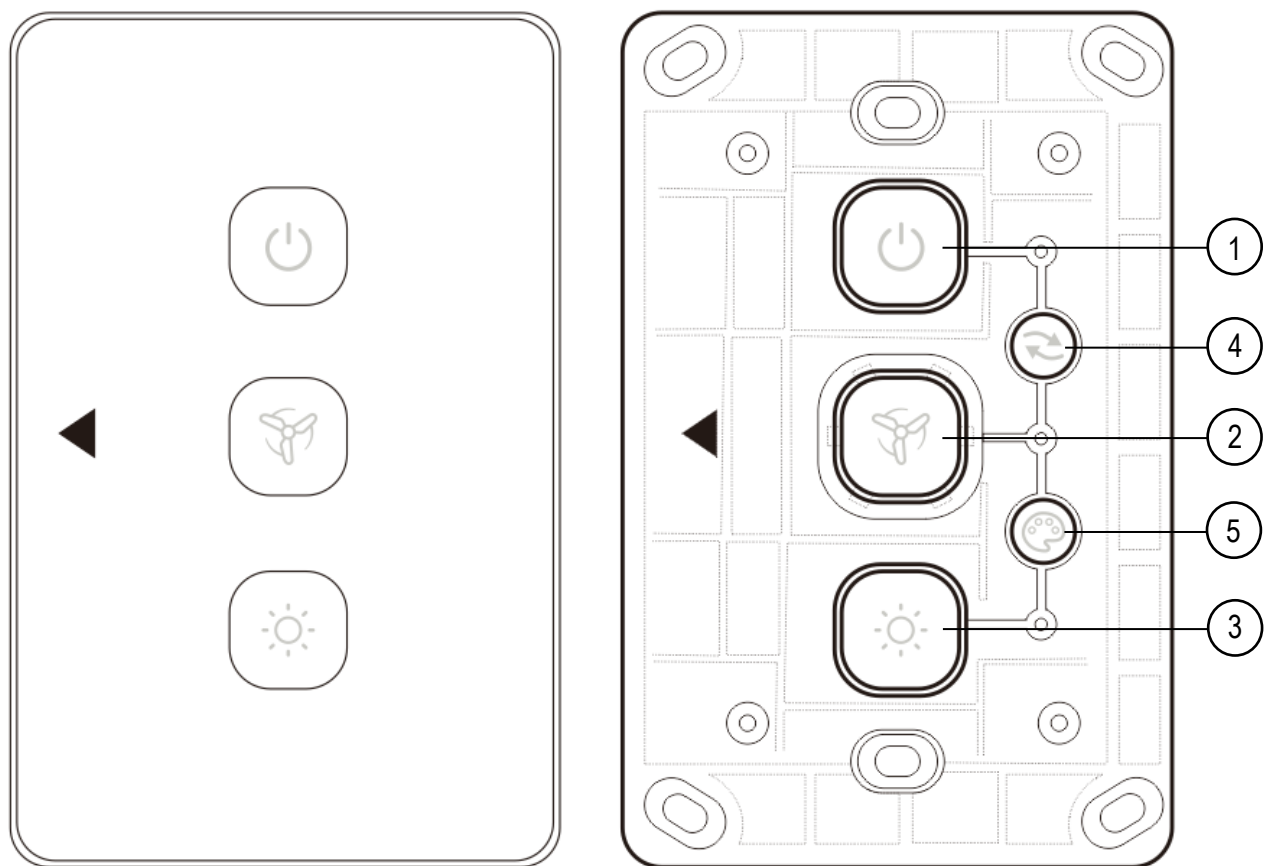

①	Short press	On/off the fan
	Long press	Isolate switch (connecting/cut off the power supply)
②	Short press	Changes the fan speed (1↔6) The number of LEDs lighting up indicates the speed of the fan.
③	Short press	On/off the light
	Long press	Dimming the light
④	Short press	Forward/Reverse (need to change during fan is running)
⑤	Short press	Change the color of the light

③ and ⑤ only applies to Colombo With Light Series.



# REMOTE CONTROLLER INSTRUCTIONS

\*Optional handheld remote controller FRM124

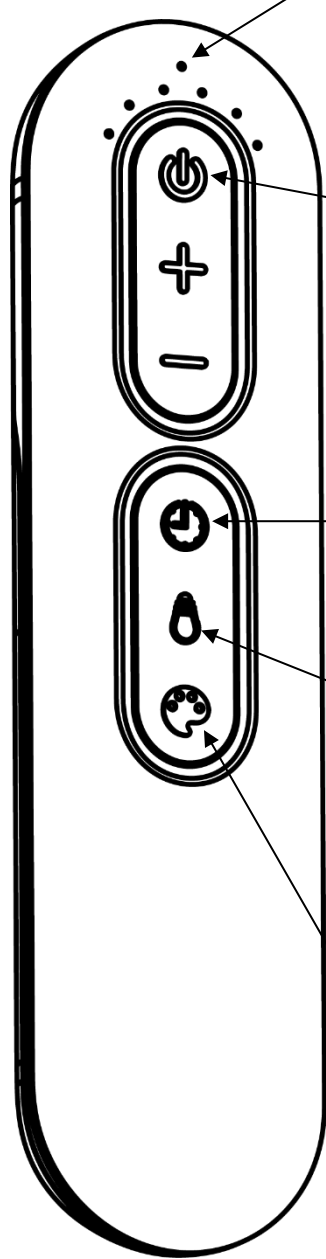

**Operation Indicating LED**  
Lights up if any key pressed.  
**NOTE1:** Change batteries if light goes dim.

**SPEED/Timer Indicator Light**

**Fan ON/OFF**

**Fan SPEED change**

**TIMER**

**For fan with LED light**  
**Brightness Adjust**  
**NOTE1:** Short Press  
ON  $\leftrightarrow$  OFF  
**NOTE2:** Press & Hold  
Dimming (brightness  $\leftrightarrow$  dimmest)  
**NOTE3:**  
Fan memorizes lighting ON/OFF state during power cut and returns to the state once power resumes.

**For fan with LED light**  
**NOTE1:** Short Press  
STEP change from Warm White, Neutral White, Cool White to Daylight White  
**NOTE2:** Hold Down  
CONTINUOUS change between limits of Warm White and Daylight White

**SPEED**

(slowest)Speed 1

Speed 2

Speed 3

Speed 4

Speed 5

(fastest)Speed 6

**TIMER (Auto Off)**

1hr

4hrs

8hrs

**F/R - Spinning Direction (Summer/Winter)**  
**NOTE1:** Open back cover to access F/R switch.  
Use downwards airflow for warmer seasons.  
Use upwards airflow for cooler seasons.

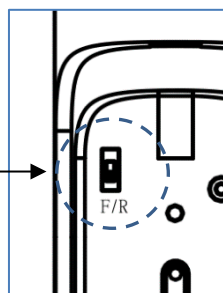

# REMOTE CONTROLLER INSTRUCTIONS

---

## SAFETY FEATURES OF REMOTE CONTROLLER

### OVERLOAD/ABNORMAL PROTECTION – RESET MOTOR CONTROLLER TO RESUME OPERATION

Should motor controller (remote receiver) of this fan detect that fan motor is under abnormal operation, it will automatically cut off power to the motor thereby **stopping fan operation immediately**.

To restart the motor controller, cut the power of the fan with the wall switch or press the OFF button if a remote handset is used.

You should first inspect and remove obstacles blocking the fan. Strong air movement by external source blowing towards fan blades can also be an obstacle to the motor controller.

NOTE: If motor controller re-enters protection mode again, it may indicate presence of a fault condition on fan motor. Please contact MERCATOR's WARRANTY DEPARTMENT for assistance. The warranty hotline can be found on the WARRANTY CARD for this product.

# INFORMATION FOR LICENSED ELECTRICIAN AND FAN OWNERS

## TROUBLESHOOTING GUIDE

Please read fault finder before calling for warranty.

### 1. FAN WILL NOT START

- I. Check that mains circuit breakers are in the ON position.
- II. Check that isolation wall switch is in the ON position.
- III. Check that batteries in the remote handset (if any) are in good condition.
- IV. Perform the code learning process manually
- V. Check that live, neutral and ground wires from isolation wall switch, remote receiver (if any) through to fan are all wired correctly in accordance with wiring diagram.
- VI. Check that all wire connections at wall switch, wire connector and/or terminal block are secured (not loosened).

### 2. FAN SOUNDS NOISY.

- I. Ensure light panel, housing screws and lamp shade are securely fitted (light version only).
- II. Re-tighten all screws on fan blades (do not over tighten).
- III. Re-tighten all screws in the hanging bracket and covering plate.

### 3. MECHANICAL NOISE

- I. Let the fan run for about 8 hours for settling in period.

### 4. FAN TURNS BUT DOES NOT MOVE MUCH AIR

- I. The fan may be running in reverse (for fans with reverse running option).
- II. The distance from the ceiling to the fan blades is too small.
- III. The room may contain items which obstruct the air flow.
- IV. The fan may be too small for the size of the room.

### 5. FAN WOBBLES

Check for wobble after each step.

- I. Check that all blade brackets are tightened securely.
- II. Most wobble problems result from inconsistent blade level. To check blade level, measure the distance from each blade tip to the ceiling. If measurements are inconsistent, adjustments of brackets will be required.
- III. Wobble problem could also result from deviations in distance from blade to blade. To check blade separation, measure the distance from blade tip to blade tip. Should measurements vary, loosen screws connecting blades and brackets (one at a time) then shift the blade to proper position and re-tighten screws.

# IMPORTANT FACTS

---

All electric motors, including fan motors make some noise and may feel hot to touch - this is not a fault. Ceiling fans tend to move during operation as they are not generally rigid-mounted. Rigid mounted ceiling fans generate excessive vibration and stress on their mountings.

Movement of a couple of centimetres is quite normal and does not suggest the fan will fall.

Please note - all ceiling fans are not the same, even in the same model some may move more or less than others.

Fan lights can rattle, if they are not supplied with the fan. They are not covered by warranty.

## FAN OPERATION

A ceiling fan is an environmentally smart choice when it comes to cooling as well as helping to warm your room. You should see a reduction in both cooling and heating costs by regular use of your fans. Do not hesitate to use your fans in both summer and winter months.

In summer place the reverse switch in the downward position (fans should spin in an anti-clockwise direction) so cool air is blowing down producing a cool breeze.

In winter, reverse the switch (fan should spin in clockwise direction) so that an upward airflow will push warm air off the ceiling and circulate it downwards into the living areas. In winter months use the fan on a lower speed than in summer.

## CLEANING & MAINTENANCE

Clean the fan using a clean, lint-free cloth or soft brush to prevent scratches to the finish of fan. Do not use abrasive agent for fan cleaning as it can damage the fan finish. To remove accumulated dust, use a slightly dampened cloth. Cleaning is recommended once a month.

## NORMAL WEAR AND TEAR

Threaded components working slightly loose, or blade carriers becoming slightly bent due to vigorous cleaning or bumping can cause extra wobble and noise. This is not covered under warranty, but a little care and maintenance can reduce or prevent this problem.

## NIGHT NOISES

This is the biggest cause of service calls, which are outside the manufacturer's warranty. If a fan has a fault it will be noticeable at all times. Naturally when everything is quiet at night you will be more inclined to hear small noises, which may not be noticeable at other times. Even slight signals super imposed in your electricity supply for off peak hot water control may cause a change in the fan motor noise. This is normal.



**PLEASE RECYCLE ALL PACKAGING MATERIAL SUPPLIED WITH THIS PRODUCT**